



HACO  
GSX 3005R

# GSX SERIES

Hydraulic Guillotine Shears



# Hydraulics

The hydraulic guillotine shears of the GSX range are driven by top mounted cylinders. Our long experience in the production of hydraulic guillotine shears guarantees a product of exceptional design and great efficiency.

The fully open rear side provides the operator the possibility of easy removal or adapting different conveying systems to the machine.

The all-welded interlocked construction makes the machine virtually indestructible. The GSX shears are well equipped and have as standard the SC101 T controller.

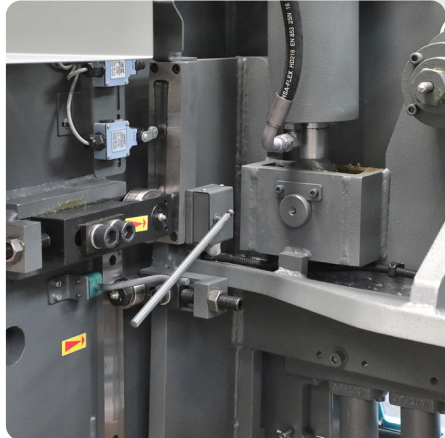

## Hydraulics

The hydraulic system consists of a motor pump group and a multifunction manifold block for the control of the machine, easy access at the side of the machine. The connections to the cylinders, the hold downs and pumps are by means of flexible hoses. Two high pressure relief valves protect the hold downs and the cutting cycle from overload. Oversized oil tank for trouble free high production shearing.

The parallelism control of the ram is based on the so-called differential principle. Guiding of the beam by roller bearings on hardened ways.

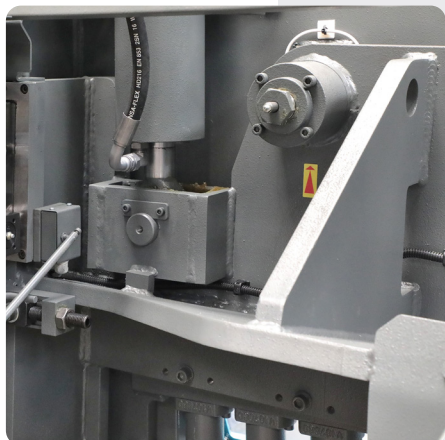

## Hydraulics hold downs

The hydraulic hold downs work independently, which makes it possible to clamp plates of different lengths and thicknesses correctly. The hold downs operate independently from the shearing pressure. On the left and the right hand side of the machine the hold downs are arranged more closely to allow cutting small plates without any problems.

# Cutting angle/blade gap adjustment

GSX 3006

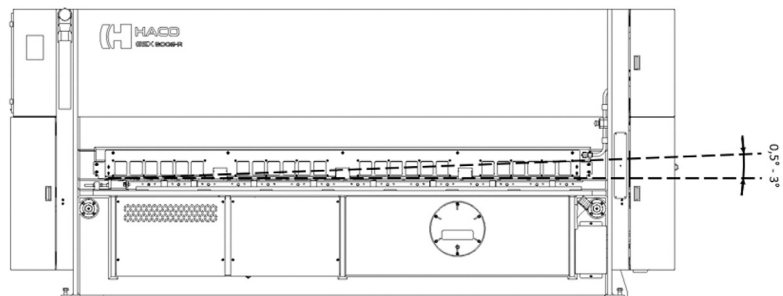

## CUTTING ANGLE ADJUSTMENT

Automatic setting as a function of the plate thickness with SC101 T control. This allows to cut thin material at a lesser angle, minimizing deformation of the sheared plate.

## BLADE GAP ADJUSTMENT

The blade clearance is set automatically by means of two hydraulic cylinders, as a function of the entered sheet thickness and material type.

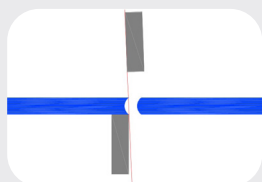

Too small

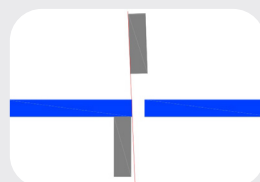

Correct

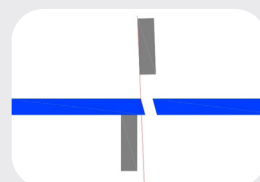

Too big

# Standard features

## Standard features of the GSX

- 2 Upper-driven push-down cylinders
- All operator controls are conveniently located at the left-hand side of the machine in the immediate reach of the operator
- Squaring arm of 1000 mm with scale, T-slot and tilling stop, attached to the left hand side of the machine
- Movable foot pedal control
- Instructions and maintenance manual
- Non-filled oil tank (because of environmental regulations)
- Service tools
- Iron square plate support blocks with ball transfers



## SC101 T Control

### Basic features

- LCD display (5.7") and Touch Screen.
- Memory capacity:  
Max. 500 programs with each max. 255 steps.  
Material list of max. 32 materials.
- Electro-hydraulic blade gap setting by means of 2 cylinders.
- Stroke control adjustment (cutting length).
- Automatic programmable retraction of the back gauge
- Possibility of jog mode on back gauge.
- Backlash compensation, delayed sheet release.
- Mode selection Inch-Metric.
- Preset counter with 0-stop.
- USB interface.

### Programming Modes

- **Automatic**  
By entering the sheet thickness, the control automatically sets the blade gap and the cutting angle as a function of the sheet thickness. All parameters can be manually modified according to the actual data
- **Manual**  
All cutting parameters such as material type, sheet thickness, cutting angle and blade gap can be programmed manually

GSX 3006

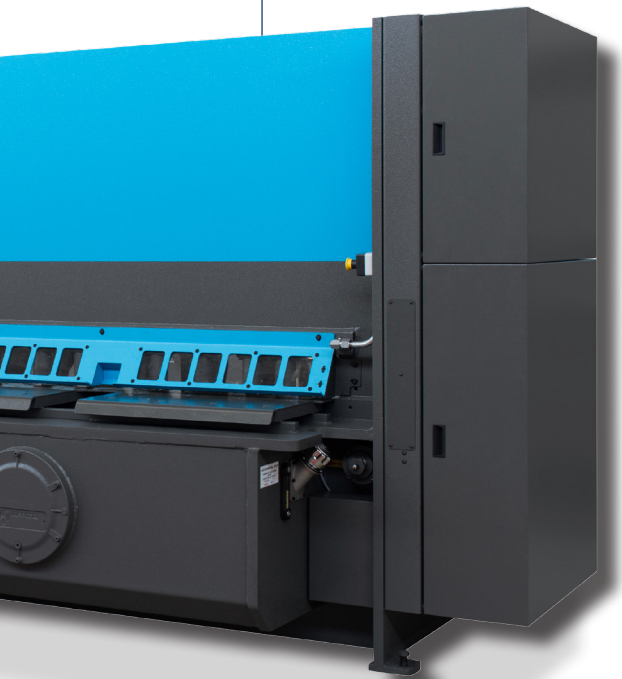

## Quick and easy

The **SCI01 T** fits all requirements for sheet cutting operations that require the highest accuracy and minimum time-loss. Creating a program requires only a few actions. The program parameters include: back gauge position, cutting time, sheet thickness, blade angle & blade gap setting. The blade gap adjustment is done electro-hydraulically.

**No specific training is required to work with this control!**

# Back gauges



The back gauge consists of 2 rigid arms (containing guidings and ball screws) and the parallel adjustable back gauge bar. This assembly assures a precise positioning of the sheet. Programmable positioning with the **SCI01 T** control. Digital read-out of the actual and preselected or programmed position. Swing-away back gauge enables cutting of sheets longer than the standard stroke length, driven on ball screws.

## Motorised back gauge (MOT)

Lateral movement front to back.  
Standard on all models.  
Powered back gauge, stroke 1000 mm.

## Swing-away back gauge (SAB)

Powered back gauge, stroke 1000 mm.  
Available as option.  
When removing the shafts in both carriers and running the backstop backwards, the complete carrier will swing away to the back, enabling to cut longer sheets.

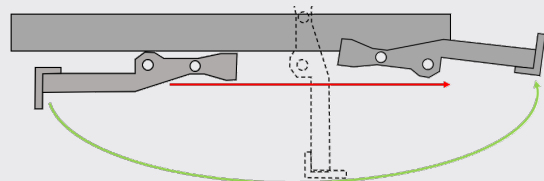

# Optional equipment

## Optionals

- Squaring arms and front support arms.
- Protractor for angle shearing.
- Hand Safety Guard with safety light curtain.
- Swing-away back gauge.
- Full table with ball transfers.
- Pendant control arm.
- Safety fences and light beams at the rear side of the machine. (standard for countries requiring the CE safety specifications)
- Soft padded hold downs.
- Hydraulic sheet support system with
- Sheet Back to Sender functionality (SBS).

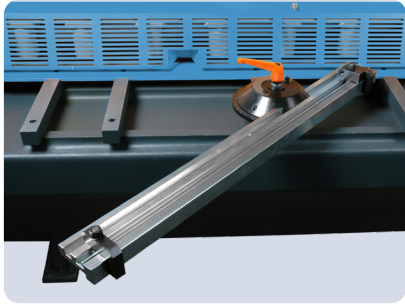

Protractor for angle shearing.

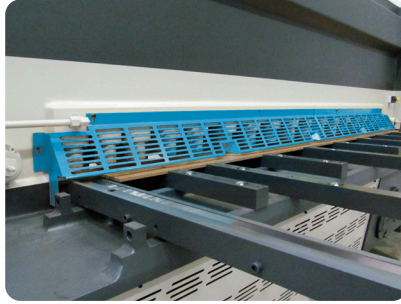

Squaring arms and front support arms with or without scale, T-slot, and tilting stop. Lengths from 1000 to 3000 mm per multiple length of 500 mm.

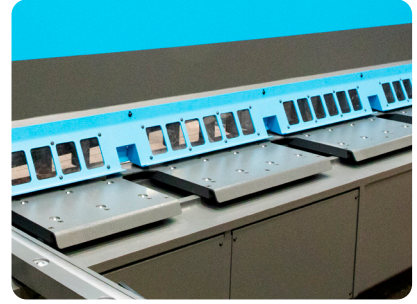

Full table consisting of segments, with ball transfers for easy feed-in of the sheets

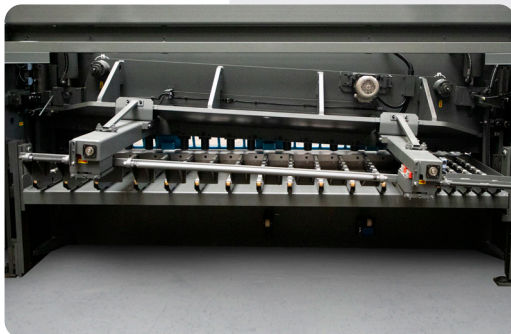
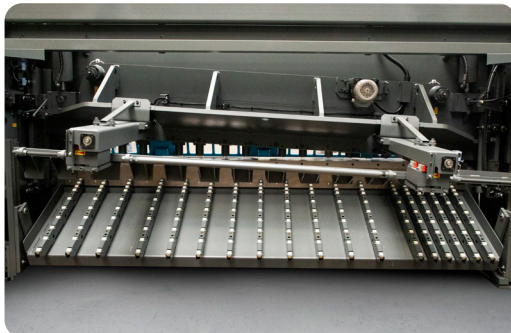

## Hydraulic sheet support system with Sheet Back to Sender (SBS)

A specific feature of the GSX range is the complete free rear space between the frames, so the machine can be executed with different sheet support systems to improve production output.

The hydraulic sheet support system follows the movement of the beam. Principally for thinner sheets, it assures the perfect gauging while entering the sheet into the machine. During the cutting action the sheet remains supported in order to avoid damage and deformation. When the cutting action is finished the plate slides down smoothly. The system can be switched off, e.g. for cutting thicker plates.

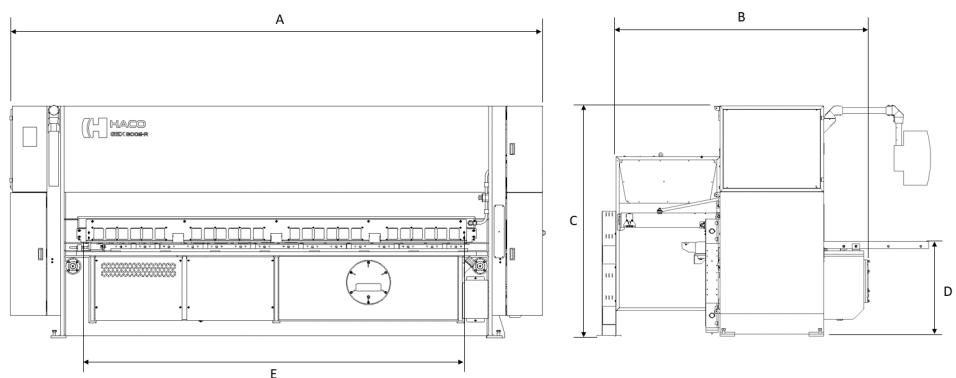

# Technical specifications

	Capacity mild steel [inch] (2400 pound/inch)	Capacity stainless steel [inch] (4000 pound/inch)	Cutting length [inch]	Cutting angle (°)	Number of plate clamps	Number of strokes/min sheet with sup- port OFF at min. angle – max. angle	Number of strokes/min with sheet sup- port ON at min. angle – max. angle	Stroke of back gauge MOT version [inch]	Stroke of back gauge SAB version [inch]	Working height [inch]	Motor Power [HP]	Length [inch]	Width [inch] (without CE safety fen- ces)	Width [inch] (with CE safety fences)	Height [inch]	Approximate weight (with SBS) [Lbs]
<b>GSX 6 x 1/4</b>	1/4"	3/16"	80	0,5-2,5	14	28-15	7,5-7,5	40	37,2	30	11	132	100	154	75	11023
<b>GSX 6 x 5/16</b>	5/16"	7ga	80	0,5-2,5	14	28-15	7,5-7,5	40	37,2	30	15	132	100	154	75	12125
<b>GSX 6 x 3/8</b>	3/8"	1/4"	80	0,5-2,5	14	14-12	8-6	40	37,2	35	18,5	144	102	162	75	14991
<b>GSX 6 x 1/2</b>	1/2"	3/8"	80	0,5-2,5	14	14-12	8-6	40	37,2	35	22,5	144	102	162	75	17637
<b>GSX 8 x 1/4</b>	1/4"	3/16"	100	0,5-2,5	14	25-12,5	6-6	40	37,2	30	11	151	100	154	75	12125
<b>GSX 8 x 5/16</b>	5/16"	7ga	100	0,5-2,5	14	25-12,5	6-6	40	37,2	30	15	151	100	154	75	13228
<b>GSX 8 x 3/8</b>	3/8"	1/4"	100	0,5-2,5	14	11-9,5	6,5-5	40	37,2	35	18,5	163	102	162	75	16535
<b>GSX 8 x 1/2</b>	1/2"	3/8"	100	0,5-2,5	14	11-9,5	6,5-5	40	37,2	35	22,5	163	102	162	83	19180
<b>GSX 10 x 1/4</b>	1/4"	3/16"	123	0,5-2,5	18	20-10	5-5	40	37,2	30	11	171	100	154	75	14330
<b>GSX 10 x 5/16</b>	5/16"	7ga	123	0,5-2,5	18	20-10	5-5	40	37,2	30	15	171	100	154	75	15432
<b>GSX 10 x 3/8</b>	3/8"	1/4"	123	0,5-2,5	18	9,5-8	5,5-4,5	40	37,2	35	18,5	183	102	161	89	18739
<b>GSX 10 x 1/2</b>	1/2"	3/8"	123	0,5-2,5	18	9,5-8	5,5-4,5	40	37,2	35	22,5	183	102	161	89	21385
<b>GSX 12 x 1/4</b>	1/4"	3/16"	147	0,5-2,5	22	16-8	4-4	40	37,2	34	11	195	100	154	83	17637
<b>GSX 12 x 5/16</b>	5/16"	7ga	147	0,5-2,5	22	16-8	4-4	40	37,2	32	15	195	100	154	83	19842
<b>GSX 12 x 3/8</b>	3/8"	1/4"	147	0,5-2,5	22	8-6,5	4,5-4	40	37,2	39	18,5	203	102	162	89	25353
<b>GSX 12 x 1/2</b>	1/2"	3/8"	147	0,5-2,5	22	8-6,5	4,5-4	40	37,2	40	22,5	203	102	162	89	26455
<b>GSX 13 x 1/4</b>	1/4"	3/16"	159	0,5-2,5	22	15-7,5	4-4	40	37,2	34	11	210	102	155	83	22046
<b>GSX 13 x 5/16</b>	5/16"	7ga	159	0,5-2,5	22	15-7,5	4-4	40	37,2	34	15	210	102	155	83	23149
<b>GSX 13 x 3/8</b>	3/8"	1/4"	159	0,5-2,5	22	7-6	4-3	40	37,2	39	18,5	223	102	162	89	28660
<b>GSX 13 x 1/2</b>	1/2"	3/8"	159	0,5-2,5	22	7-6	4-3	40	37,2	40	22,5	223	102	162	89	29762

**E**

**D**

**A**

**B**

**C**



## Machinery Masterminds

[WWW.HACO.COM](http://WWW.HACO.COM)

### **HACO Belgium**

Hogeschuurstraat 2  
8850 Ardooie  
Belgium  
+32 (0)51 26 52 00  
[sales@haco.com](mailto:sales@haco.com)

### **HACO India**

Plot No. 122A, Sector 6  
MT, Bawal, Distt. Rewari Haryana,  
India, 123501  
+919996246805  
[sales@haco-india.com](mailto:sales@haco-india.com)

### **HACO USA**

11629 N. Houston Rosslyn Rd.  
Houston, TX 77086  
USA  
+1 281 445-3985  
[sales.tx@hacoatlantic.com](mailto:sales.tx@hacoatlantic.com)

### **HACO Slovakia**

Ulica 1. Mája 1850  
031 80 Liptovský Mikuláš  
Slovakia

### **HACO France**

Parc d'activé de la Houssoye  
Rue René Laënnec  
59253 La Chapelle D'Armentieres  
France  
+33 3 20 10 30 40  
[commercial@haco.fr](mailto:commercial@haco.fr)

### **HACO Australia**

16 Argong Chase  
Cockburn Central WA 6164  
Australia  
+61 0 8 9414 7382  
[sales@hacoaustralia.com.au](mailto:sales@hacoaustralia.com.au)

GSX / 03.2024

This catalog is not a contractual document and only for illustrative purposes. Haco reserves the right to modify any specifications within this catalog without prior notice.